

“INTEGRATED COMFORT” PALMIPÉDES RANGE



**RICHEL
LIVESTOCK**



More than 35 years of experience

It was during the first years of the company that

RICHEL developed its range of livestock structures, which offer exceptional zootechnical performances for much lower investment than a traditional building.

Nowadays, many farms have chosen RICHEL LIVESTOCK. The "Integrated Comfort" range is the result of thirty-five years in contact with stock farmers.

The power of an international group.

Present in more than 70 countries, quoted on the open market of the Paris stock exchange, the RICHEL group puts at your service the leading industrial and technological power in the market.

Preferred partner of the agricultural world, we respond to the needs of livestock, storage, horticulture, market gardening and through its subsidiary MARCHEGAY he is also the number one constructor of garden centres in France.

A Research and Development department specialised in livestock.

Inside our R & D department, the design of products for livestock is under the responsibility of a specialised service

trained in the technologies of livestock structures. Our livestock team is equipped with the most potent computer-assisted design programs.

Cost control by integration of the production.

Concentrated at our Eygalières site, the production of our stock-raising structures is fully integrated. In this manner, we make our own tubes and we process more than 12 000 tons of galvanised steel per year. This is a key factor in our quality control and competitiveness.

Close to you, construction teams trained for RICHEL LIVESTOCK.

Near to you, in France or abroad, our construction teams have been trained under real conditions at our training centre in Eygalières.

The commitment of RICHEL LIVESTOCK.

- Exceptional zootechnical performances for controlled investment.
- The polyvalence of the investment that can be adapted to market's evolution.
- The choice of an efficient model adapted to your budget.





Ready to feed stock



Feeding room



Ready to feed stock



Feeding room



Ready to feed stock



Duck stock for meat



The comfort of the animal is, as you know, the key to successful livestock. The RICHEL "Integrated Comfort " range brings together all the factors that contribute to its optimisation.

CLADDING

Control of interior temperature is a major factor in livestock management.

Therefore the concept :

- Outside layer in coated PVC sheet, 550 g/m² (type wagon sheet) or polyethylene film green/green 250 microns thick,
- Glass wool 80 mm thick, 160 mm or more, type building felt IBR covered with Kraft paper acting as vapour-guard,
- Inside layer in polyethylene film black/white, 160 to 200 microns thick,

enables maintenance of an adequate temperature for the well-being of your animals and thus to optimize palmipedes batches homogeneity.

Film fixing is by means of RICHEL clips for rapid and reliable cladding.

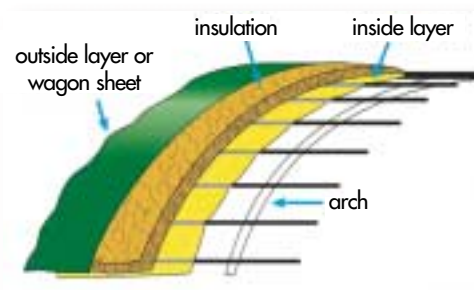

Exploded view of the cover and insulation.



Film fixing : Richel clips

STATIC VENTILATION

The multiple options in our range of ventilation systems bring the solutions best adapted to your farm and your climate. Combinations of these systems can give even higher performance.



1



2

❶ Exterior side vent of 1 m wide, operated by drive tube and rack and pinions, manual, motorized and/or automatic. It can be completely insulated, as the cladding, and fitted with anti-bird netting.

❷ Gravity side vent of 1 m height in woven sheet or PVC coated sheet 550 g/m², mounted on ø 20 tube and operated by winch, manual, motorized and/or automatic. May be fitted with anti-bird netting.



3



4

❸ Interior side vent : air entry is by means of a skirt system which allows ventilation even in windy or rainy conditions. With a width of 60 cm it is operated by cable and winch, manual, motorized and/or automatic.

❹ Ridge skylight, 0.4 m wide and of modular length, it facilitates the evacuation of hot air by a chimney effect. Operated by cable and winch, manual, motorized and/or automatic.



5

❺ Air extraction chimneys in High Density Polyethylene, with movable vent cap of shifting cones, adjustable seal register with counter-weight operated by winch, manual or motorized.



6

❻ Opening half-moons or frames placed at the top of the gables facilitate the evacuation of the pocket of hot air that can accumulate at the ridge. Operated by cable and winch or drive tube and rack and pinions, manual and/or automatic.

DYNAMIC VENTILATION

Improve the "Integral Comfort" of your animals and your working conditions to increase profitability.



1



2

❶ Dynamic ventilation using ventilators, extractors or circulation fans combined with humidifying systems (type cooling ❷) can be fitted to our gables and long sides.

WORKING COMFORT



The high volume of our shelters associated with their high capacity side clearance simplifies the everyday manoeuvres of cleaning and circulation. Gaining time means increasing profitability.

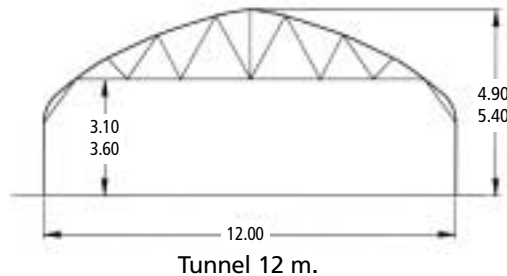
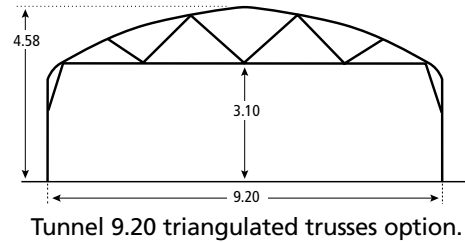
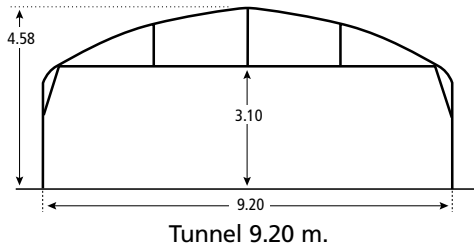
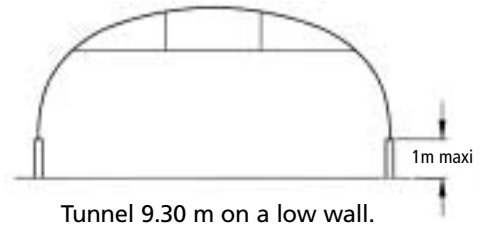
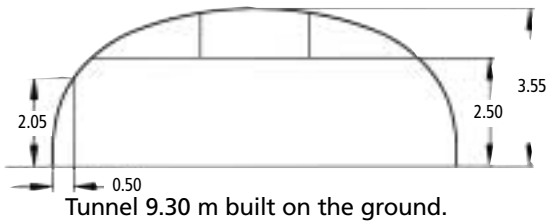

STURDINESS



The framework is made from steel plate galvanised to standards, EN 10147 Z275 o Z450 by the Sendzimir process, it meets the French standards NF U 57-063, NF U 57-064 or the DTU P 06-002 and DTU P 06-006 (for the 9.20 m and 12 m models exclusively).

Thanks to the work of our R & D department, rapidity (picture 1) of construction and sturdiness (picture 2) go together.



Post bead



Weld-free reversible clamps (Richel patent)

YOUR AGENT IN RICHEL LIVESTOCK



RICHEL LIVESTOCK. **RICHEL**
INSISTING ON INNOVATION. **E L E V A G E**